

Soils Map

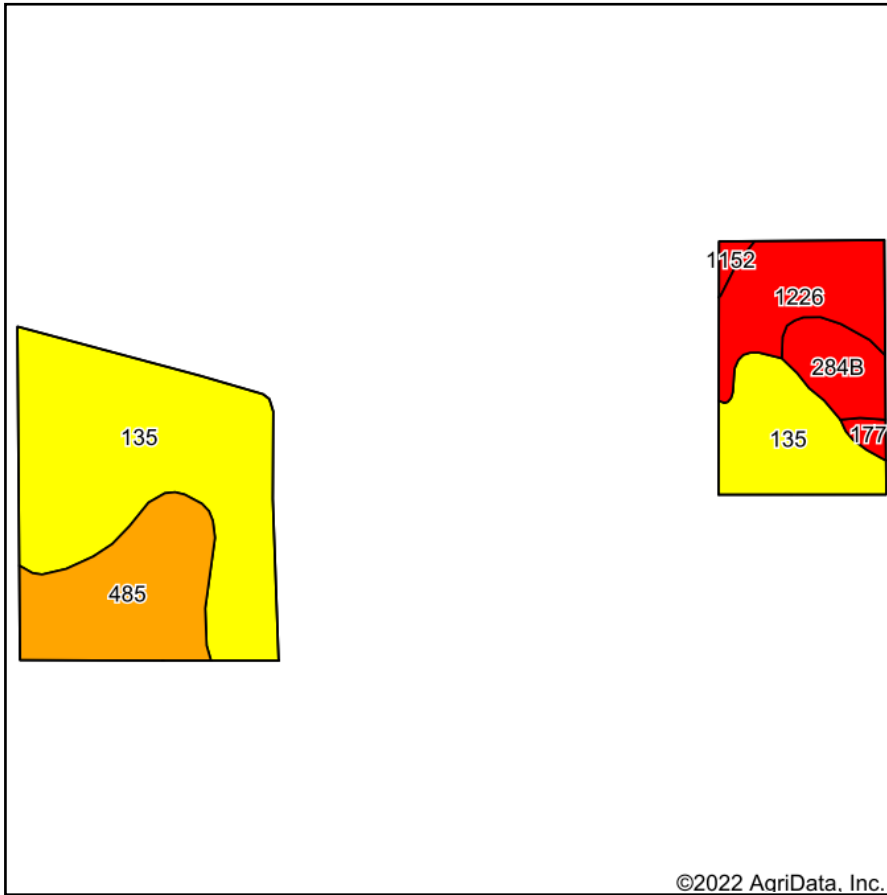

Soils data provided by USDA and NRCS.

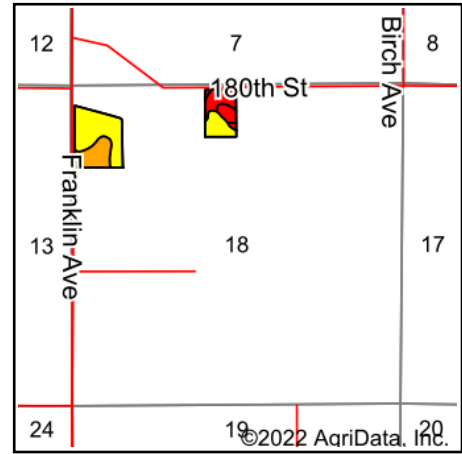

State: **Iowa**
 County: **Butler**
 Location: **18-92N-18W**
 Township: **Pittsford**
 Acres: **25.75**
 Date: **11/23/2022**



Maps Provided By:



© AgriData, Inc. 2021

www.AgriDataInc.com



Area Symbol: IA023, Soil Area Version: 28

Code	Soil Description	Acres	Percent of field	CSR2 Legend	Non-Irr Class *c	CSR2**	CSR	*n NCCPI Overall	*n NCCPI Corn	*n NCCPI Small Grains	*n NCCPI Soybeans	*n NCCPI Cotton	
135	Coland clay loam, 0 to 2 percent slopes, occasionally flooded	15.04	58.4%	Yellow	llw	65	80	87	87	44	66		
485	Spillville loam, 0 to 2 percent slopes, occasionally flooded	5.14	20.0%	Orange	llw	76	92	87	87	51	74		
1226	Lawler loam, 0 to 2 percent slopes, rarely flooded	3.46	13.4%	Red	lls	59	72	83	83	70	60	1	
284B	Flagler sandy loam, 2 to 5 percent slopes	1.65	6.4%	Red	llle	51	50	65	65	50	42		
177	Saude loam, 0 to 2 percent slopes	0.26	1.0%	Red	lls	60	63	78	78	65	61		
1152	Marshan clay loam, 0 to 2 percent slopes, rarely flooded	0.20	0.8%	Red	llw	54	68	81	81	65	60		
Weighted Average						2.06	65.4	79.1	*n 84.9	*n 84.9	*n 49.7	*n 65.2	*n 0.1

**IA has updated the CSR values for each county to CSR2.

*n: The aggregation method is "Weighted Average using all components"

*c: Using Capabilities Class Dominant Condition Aggregation Method

Soils data provided by USDA and NRCS.