

Soils Map

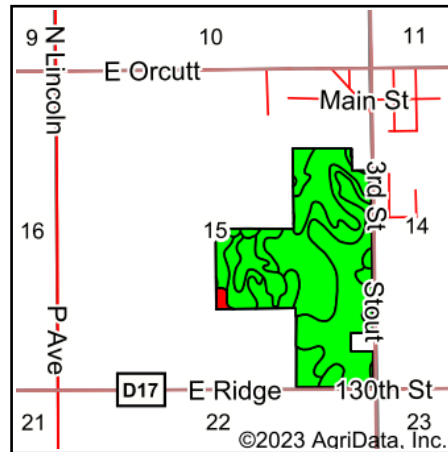

State: **Iowa**
 County: **Grundy**
 Location: **15-89N-16W**
 Township: **Beaver**
 Acres: **149.31**
 Date: **8/18/2023**

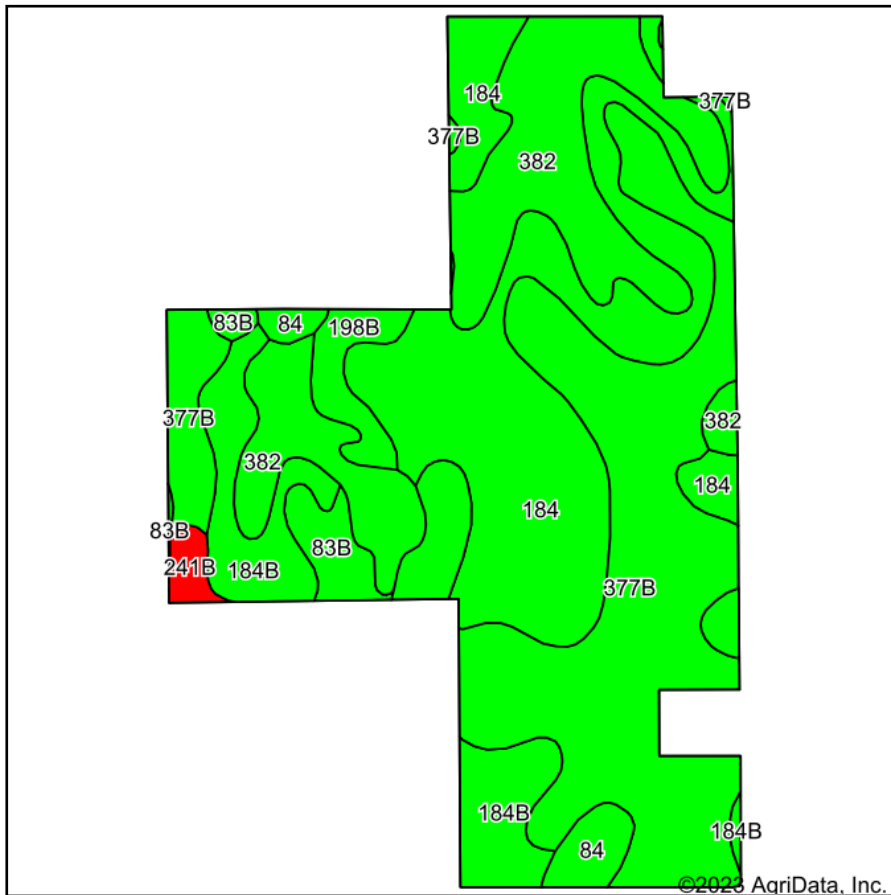

Soils data provided by USDA and NRCS.

Area Symbol: IA075, Soil Area Version: 28

Code	Soil Description	Acres	Percent of field	CSR2 Legend	Non-Irr Class *c	CSR2**	CSR	*n NCCPI Overall	*n NCCPI Corn	*n NCCPI Small Grains	*n NCCPI Soybeans	
377B	Dinsdale silty clay loam, 2 to 5 percent slopes	52.82	35.4%		Ile	94	90	87	87	68	74	
184	Klinger silty clay loam, 1 to 4 percent slopes	41.49	27.8%		Iw	95	95	88	88	79	82	
382	Maxfield silty clay loam, 0 to 2 percent slopes	29.24	19.6%		Ilw	87	90	79	79	53	67	
184B	Klinger silty clay loam, 2 to 5 percent slopes	13.51	9.0%		Ile	95	90	88	88	79	82	
83B	Kenyon loam, 2 to 5 percent slopes	3.80	2.5%		Ile	90	86	87	86	66	71	
198B	Floyd loam, 1 to 4 percent slopes	3.73	2.5%		Ilw	89	80	88	83	63	88	
84	Clyde silty clay loam, 0 to 3 percent slopes	3.30	2.2%		Ilw	88	76	90	90	74	85	
241B	Saude-Lilah complex, 2 to 5 percent slopes	1.42	1.0%		Ile	48	58	65	65	60	44	
Weighted Average						1.72	92.2	90.4	*n 85.7	*n 85.5	*n 69	*n 75.8

**IA has updated the CSR values for each county to CSR2.
 *n: The aggregation method is "Weighted Average using all components"
 *c: Using Capabilities Class Dominant Condition Aggregation Method
 Soils data provided by USDA and NRCS.