

# Soils Map

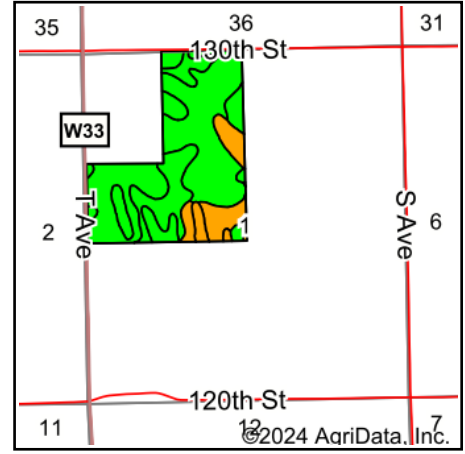

State: **Iowa**  
 County: **Fayette**  
 Location: **1-92N-10W**  
 Township: **Fremont**  
 Acres: **137.17**  
 Date: **1/17/2024**

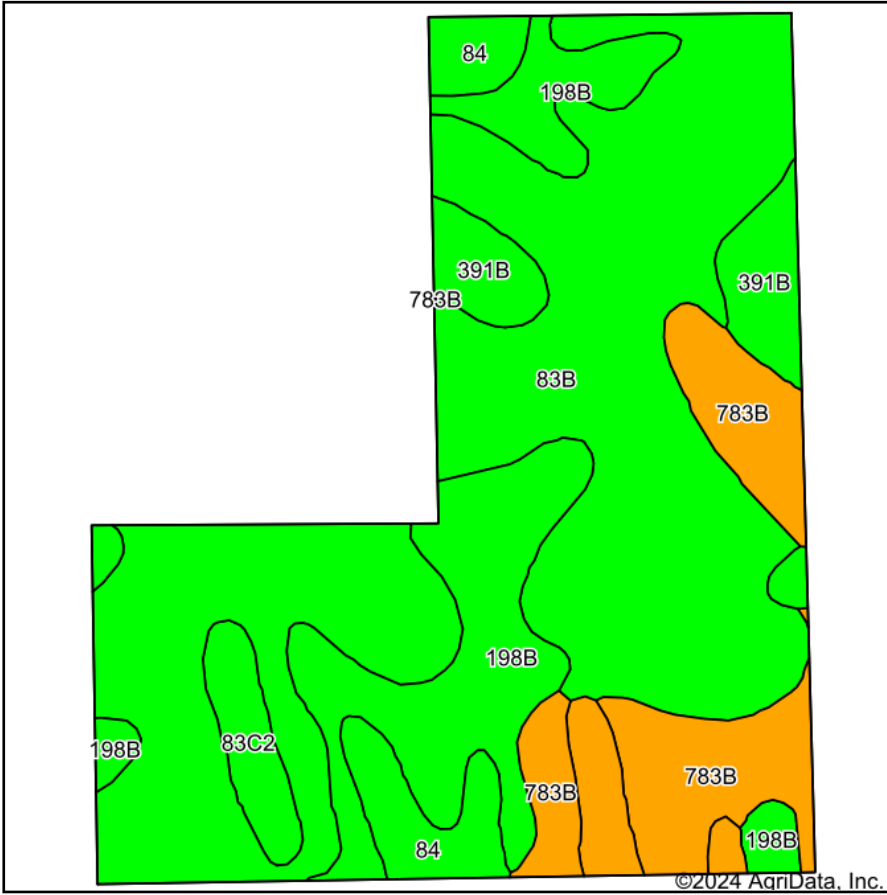

Maps Provided By:



Soils data provided by USDA and NRCS.

Area Symbol: IA065, Soil Area Version: 28

Code	Soil Description	Acres	Percent of field	CSR2 Legend	Non-Irr Class *c	CSR2**	CSR	Brome grass alfalfa AUM	Brome grass alfalfa hay Tons	Corn Bu	Kentucky bluegrass AUM	Oats Bu	Smooth brome grass AUM	Soybeans Bu	*n NCCPI Overall	* N C
83B	Kenyon loam, 2 to 5 percent slopes	75.60	55.1%		Ile	90	85								89	
198B	Floyd loam, 1 to 4 percent slopes	24.01	17.5%		Ilw	89	80								88	
783B	Cresco loam, 2 to 5 percent slopes	16.35	11.9%		Ile	73	65								76	
391B	Clyde-Floyd complex, 1 to 4 percent slopes	7.54	5.5%		Ilw	87	73								89	
84	Clyde clay loam, 0 to 3 percent slopes	6.71	4.9%		Ilw	88	75								90	
83C2	Kenyon loam, 5 to 9 percent slopes, eroded	3.76	2.7%		Ille	84	68	10.6	6.3	212	3.7	88	6.2	61	82	

Soils data provided by USDA and NRCS.



Code	Soil Description	Acres	Percent of field	CSR2 Legend	Non-Irr Class *c	CSR2**	CSR	Bromegrass alfalfa AUM	Bromegrass alfalfa hay Tons	Corn Bu	Kentucky bluegrass AUM	Oats Bu	Smooth bromegrass AUM	Soybeans Bu	*n NCCPI Overall	*n C
783C	Cresco loam, 5 to 9 percent slopes	3.20	2.3%		IIIe	79	45									81
<b>Weighted Average</b>						<b>2.05</b>	<b>87.1</b>	<b>79.2</b>	<b>0.3</b>	<b>0.2</b>	<b>5.8</b>	<b>0.1</b>	<b>2.4</b>	<b>0.2</b>	<b>1.7</b>	<b>*n 86.9</b>

\*\*IA has updated the CSR values for each county to CSR2.

\*n: The aggregation method is "Weighted Average using all components"

\*\*IA has updated the CSR values for each county to CSR2.\*c: Using Capabilities Class Dominant Condition Aggregation Method