

# Soils Map

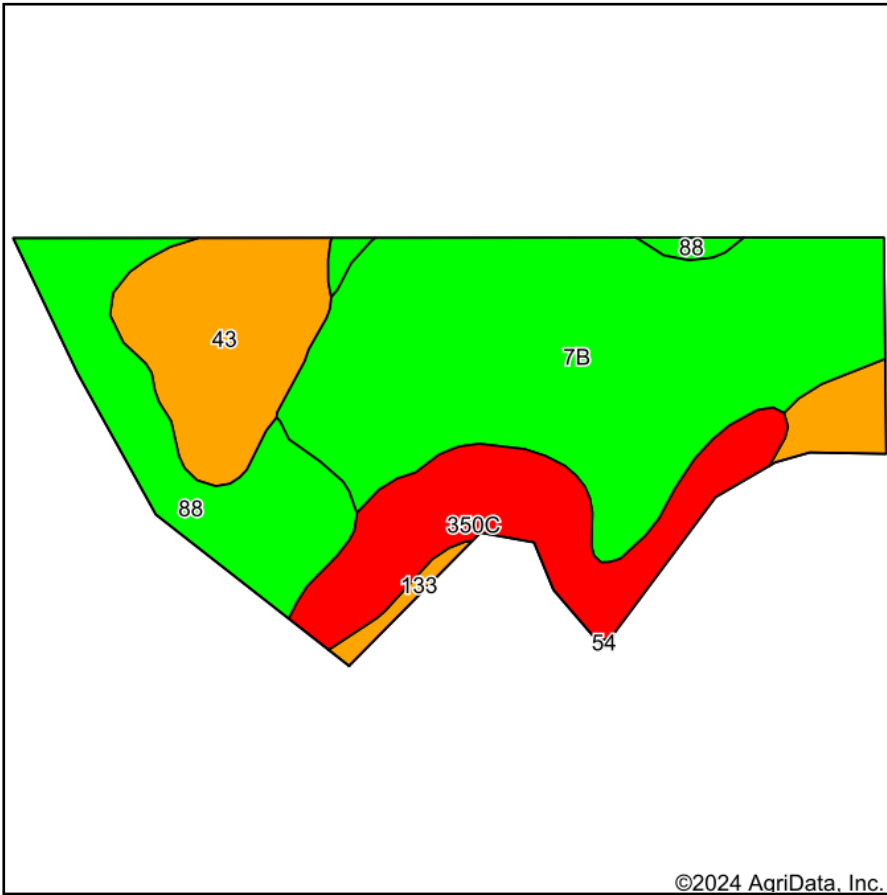

Soils data provided by USDA and NRCS.

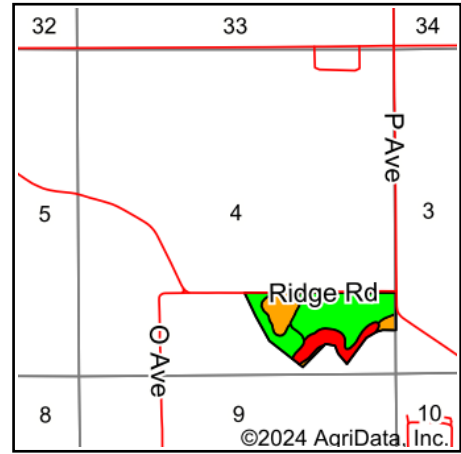

State: **Iowa**  
 County: **Tama**  
 Location: **4-85N-14W**  
 Township: **Perry**  
 Acres: **48**  
 Date: **8/21/2024**



Maps Provided By:



Area Symbol: IA171, Soil Area Version: 28													
Code	Soil Description	Acres	Percent of field	CSR2 Legend	Non-Irr Class *c	CSR2**	CSR	*n NCCPI Overall	*n NCCPI Corn	*n NCCPI Small Grains	*n NCCPI Soybeans	*n NCCPI Cotton	
7B	Wiota silt loam, 2 to 5 percent slopes, rarely flooded	23.21	48.4%		I	95	90	92	92	75	80		
43	Bremer silty clay loam, 0 to 2 percent slopes, occasionally flooded	8.34	17.4%		IIw	74	82	77	77	69	65		
350C	Waukegan silt loam, 5 to 9 percent slopes	7.99	16.6%		IIIe	50	48	83	83	73	62		
88	Nevin silty clay loam, 0 to 2 percent slopes	7.96	16.6%		Iw	95	90	97	97	77	87	1	
133	Colo silty clay loam, 0 to 2 percent slopes, occasionally flooded	0.50	1.0%		IIw	78	85	77	77	34	75		
<b>Weighted Average</b>						<b>1.52</b>	<b>83.7</b>	<b>81.6</b>	<b>*n 88.6</b>	<b>*n 88.6</b>	<b>*n 73.5</b>	<b>*n 75.5</b>	<b>*n 0.2</b>

\*\*IA has updated the CSR values for each county to CSR2.

\*n: The aggregation method is "Weighted Average using all components"

\*c: Using Capabilities Class Dominant Condition Aggregation Method

Soils data provided by USDA and NRCS.